



Main Features:-

- ♦ Full Bore Ball Valve
- ♦ DN10 to DN25 PN25
- ♦ BSP F-F Ends
- ♦ Working Temperature -20°C to 110°C *
- ♦ Maximum working pressure 25 bar

*Temperature and pressure determined by valve body, seat etc.

Suitable Applications & Approvals:



HVAC



OIL



GAS



INDUSTRY



SERIES: 80058

MANUFACTURER: **GENEBRE**

VALVE MATERIALS & DIMENSIONS

ITEM	SECTION	MATERIAL	ADDITIONAL INFO / OPTIONS
1	Body	Brass	Peened + Chromed
2	Cap	Brass	Peened + Chromed
3	Ball	Brass	Chrome Plated
4	Stem	Brass	Chrome Plated
5	Ball Seat	PTFE	n/a
6	Stem Packing	PTFE	n/a
7	O'Ring	NBR	n/a
8	Stem Ring	Brass	Chrome Plated
9	Nut	Brass	Chrome Plated
10	T-Handle	Aluminium	Painted
11	Nut	Brass	Chrome Plated

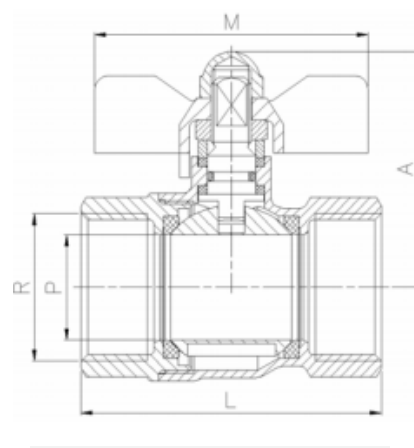
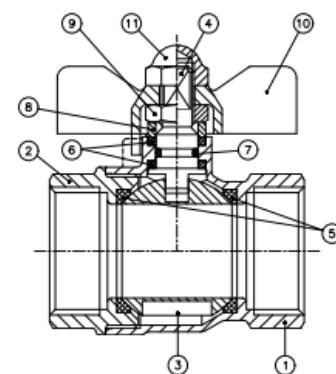

REF	SIZE	DN	P	A	L	M	Kg
80058-02	1/4"	10	10	38	40	50	0.090
80058-03	3/8"	10	10	38	43	50	0.100
80058-04	1/2"	15	15	40	49	50	0.145
80058-05	3/4"	20	20	50	56	62	0.240
80058-06	1"	25	25	53	68	62	0.360



T

+44 (0)1386 552369

E

sales@allvalves.co.uk

W

www.allvalves.co.uk

F

+44 (0)1386



Genebre are a global brand of industrial valves with large stocks held for fast delivery on various type of valves, sizes, end connections and materials.

SERIES: 80058

REF	SIZE	TORQUE Nm	REF	SIZE	Kv
80058-02	1/4"	N/A	80058-02	1/4"	3.5
80058-03	3/8"	N/A	80058-03	3/8"	5.5
80058-04	1/2"	N/A	80058-04	1/2"	16
80058-05	3/4"	N/A	80058-05	3/4"	30
80058-06	1"	N/A	80058-06	1"	45

- The liquid listed in the table are initial breakaway torques, taken with liquids and lubricant media.

- Please regard these as approximate values, as the objective value on different factors like pressure, medium, rubber

PRESSURE AND TEMPERATURE CHART

GENEBRE

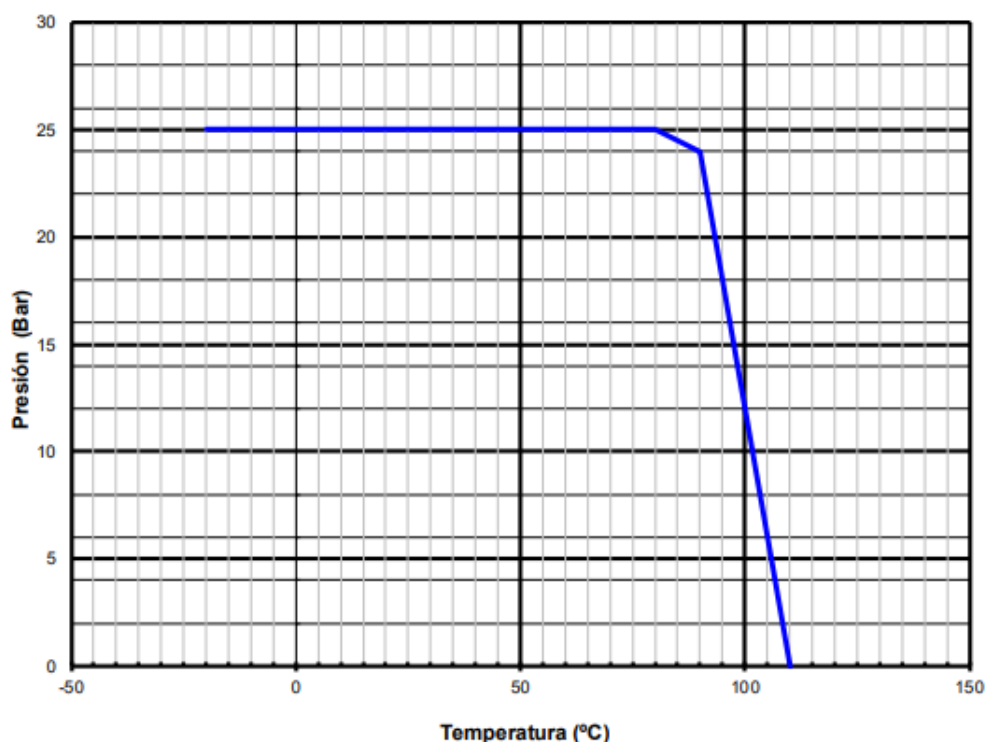

Genebre is a leading company and world reference in fluid control and high-quality taps. They control all the creation processes, responding to the specific needs of each market: from the initial concept and design of the product to the production and commercialization.

